

## FS series fixed barcode scanner quick guide

- ☞ The working voltage for the scanner is 5V. The user must carefully check the power supply's working voltage before connecting the scanner to the device, particularly in the use of an external adaptor for RS232 cable.
- ☞ A standard packing includes a scanner, a cable (USB, or RS232, or PS2) and a CD.
- ☞ Use a piece of dry and soft cloth when cleaning the scanner.

### Parts of the scanner

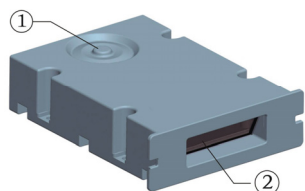

- ① Button
- ② Exit window

### Installing the cable

1. Switch off the host.
2. Refer to the below pictures, connect the host with the scanner based on different cables.
3. Ensure that all connections are secure.
4. Switch on the host system. If installation is successful, the beeper will beep.

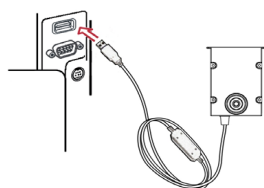

USB cable

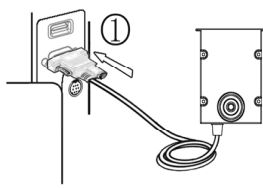

RS232 cable

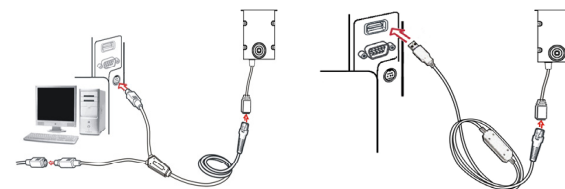
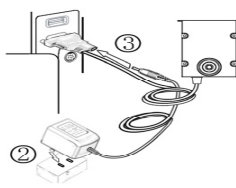

PS2 cable

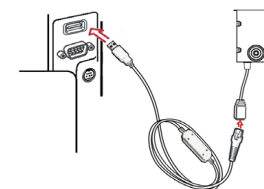

Switching PS2 cable to  
USB cable

### Special setting



Default value initialization



Firmware version list

### Operate the scanner by receiving command via UART

1. The scanner with RS232 cable or USB cable supports this operating mode.
2. If the scanner is with USB cable, the setting of USB device type must be set as "USB virtual COM".
3. Please refer to the user manual for details.

### Scanning mode

There are three types of scanning mode for the scanner. The switch of scanning mode can be done by scanning a serial of setting barcodes. The default scanning mode is "Single scan".

1. **Single scan**-The trigger button must be pressed once, or when the scanner receives an associated UART command, to activate scanning.
2. **Continue scan**-The trigger button acts as a toggle switch. Press button to activate or stop continue-scanning mode. The scanner can have the same operation by receiving associated UART command.
3. **Auto-detection**-By setting Enable, the scanner will start operating if any nearby object has been detected. The laser light of scanner stops scanning when there is a successful reading or no code is decoded after the default interval elapsed. Once the laser light stops scanning, the present object must be removed to enable auto-detect sensor.